

Survey Lower Broad Oak Rd South 1<sup>st</sup> Draft

Surveyed ? 2017

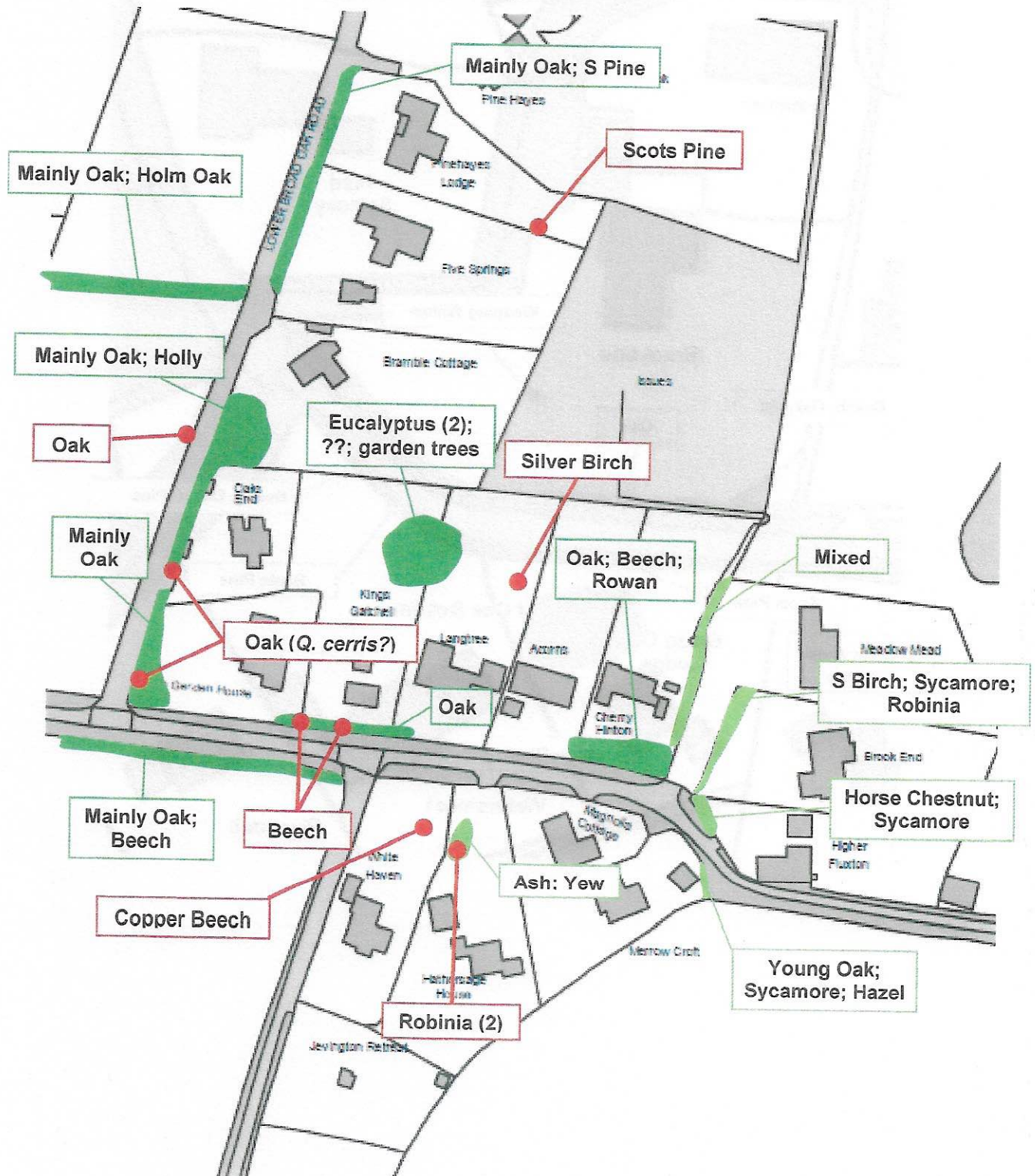

WEST HILL Tree survey - Lower Broad Oak Road - sheet 4 15

1	Scots Pine	17	600 V	A-	c	
1	Oak	24	700 V	A	a	White Haven
2	Copper Beech	22	1000 V	A*	a	
3	Robinia	18	550 V	A	b	2nr. Hathersage House
4	Beech	22	650 V	A	a	Kings Gatchell
5	Oak	18	700 V	B	a	
6	Beech	24	800 V	A	a	
7	Oak	18	700 V	B	b	
8	Silver Birch					Downalong felled
9	Oak	20	800 V	A	a	Browns
10	Oak	22	700 V	A	c	
11	Scots Pine	22	900 V	A	c	Oaks End
LHS Oak Lane trees opposite end of LBOR						
1	Oak	25	800 V	A	a	
2	Oak	22	800 V	A	a	
3	Oak	17	500 V	C	d	
4	Oak	22	750 V	B	b	
5	Oak	25	800 V	A	a	
6	Oak	25	750 V	A	a	

Age Y=0>20yrs, M/A=20>40yrs, M=40>60yrs, V=>60yrs Condition A-tree of quality, B-makes significant contribution, C-some contribution, R-dead / any quality lost in 10yrs. Shape a - oval, c - fan, d - column, e - cone - height in metres - diameter @ 1.5m above ground level